

Revisions			
Rev	Description	Date	Approved:
A	Initial Release	2015.2.27	A. M

**ELECTRICAL PERFORMANCE**

- 1. Frequency Range: 7.2-8.4 GHz
- 2. Insertion Loss: 0.2 dB max.
- 3. Isolation: 21 dB min.
- 4. VSWR: 1.20 max.
- 5. Forward Power: 100W
- 6. Waveguide Type: WR112

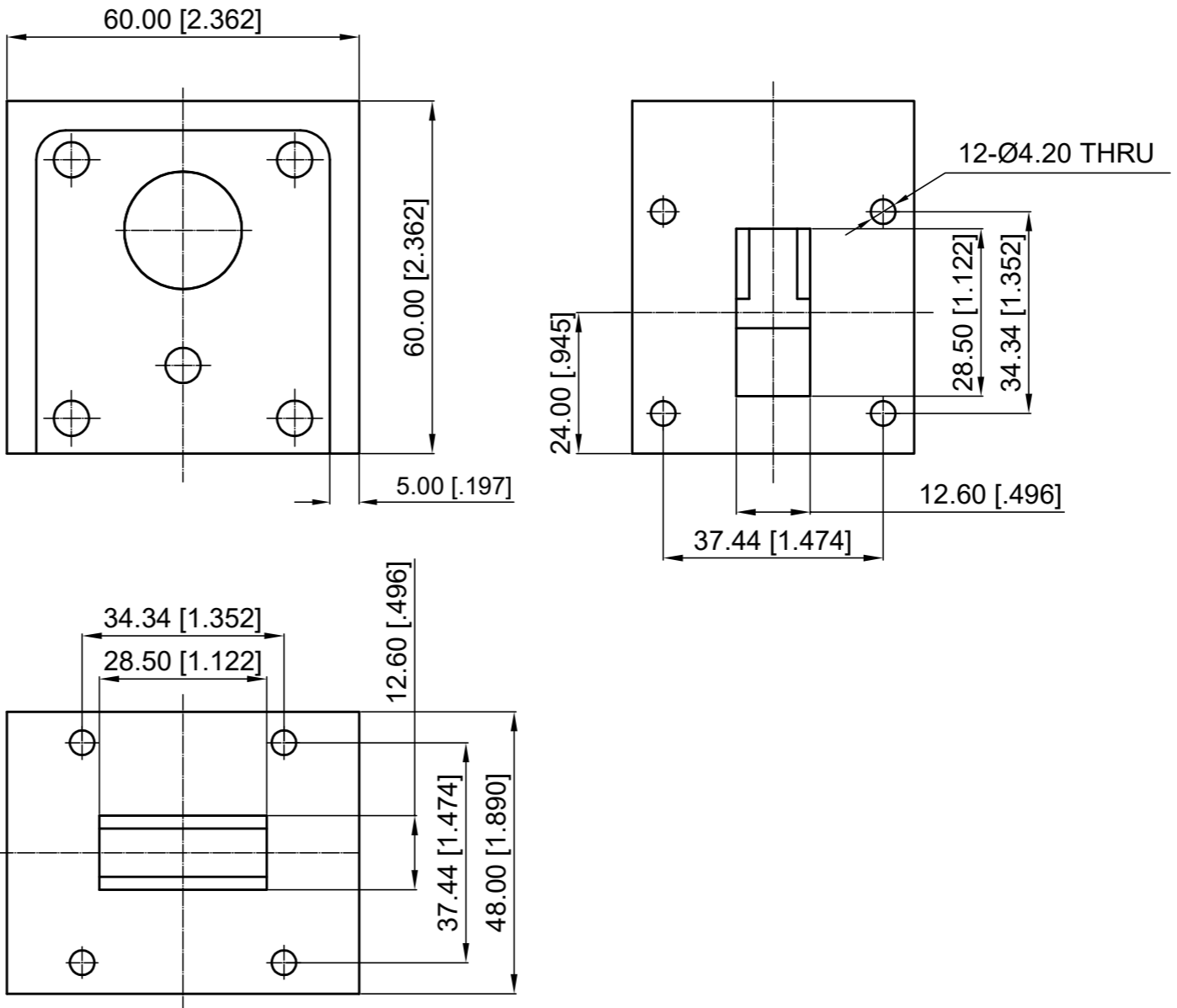

NOTES:

- 1. ALL SPECIFICATIONS ARE SUBJECT TO CHANGE WITHOUT NOTICE AT ANY TIME
- 2. CUSTOMER OUTLINE DRAWING FOR REFERENCE ONLY

Drawn:	W. Y 2015.2.27
Checked:	T. L 2015.2.27
Approved:	A. M 2015.2.27
Unless Otherwise Specified Dimensions are in Millimeters, Dimensions in [ ] are in Inches for Customer Reference Only. Unless Otherwise Specified Tolerance are: .XX ±0.13 [.005"] .X ±0.20 [.008"] X ±0.50 [.019"] .X° ±1° X° ±2°	

Title:	WR112 Circulator Freq 7.2~8.4 GHz
Part No:	DWC112F7284



View:	
Size:	A3
Scale:	1:1
Sheet:	1/1
Rev:	A