

Performance Features

Nominal Impedance: 50Ω

Frequency Range: DC-40 GHz

Durability: 500 Cycles

Operating Temperature: -55°C~+165°C

Materials/Finishes

Housing: Type 303 Stainless Steel - Polished & Passivated

Center Contact: Beryllium Copper Plated Gold

Insulators: PEI

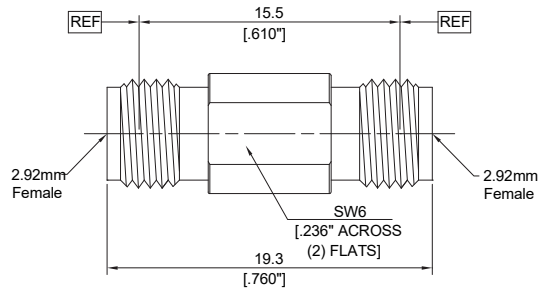

P/N	DPA23023001
Descr.	2.92mm F to 2.92mm F
Freq.	DC-40GHz
VSWR	1.20:1(Max)

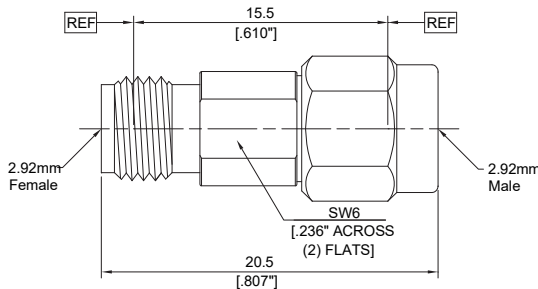

P/N	DPA23023102
Descr.	2.92mm F to 2.92mm M
Freq.	DC-40GHz
VSWR	1.15:1(Max)

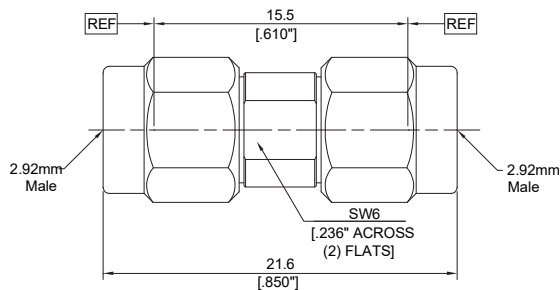

P/N	DPA23123103
Descr.	2.92mm M to 2.92mm M
Freq.	DC-40GHz
VSWR	1.15:1(Max)

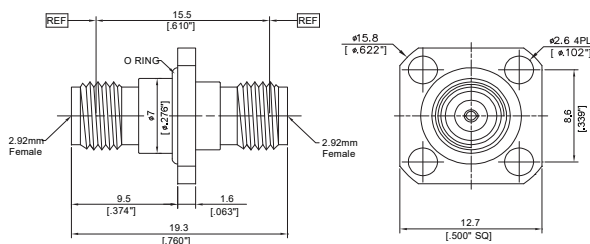

P/N	DPA23023004
Descr.	2.92mm F to 2.92mm F, Flange
Freq.	DC-40GHz
VSWR	1.20:1(Max)

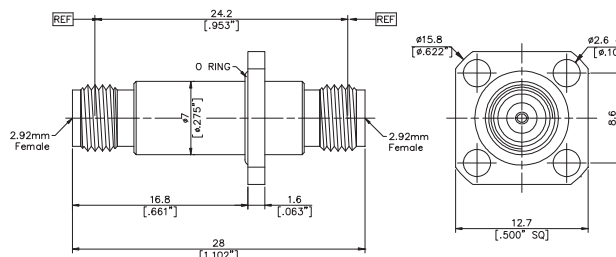

P/N	DPA23023005
Descr.	2.92mm F to 2.92mm F, Flange
Freq.	DC-40GHz
VSWR	1.20:1(Max)

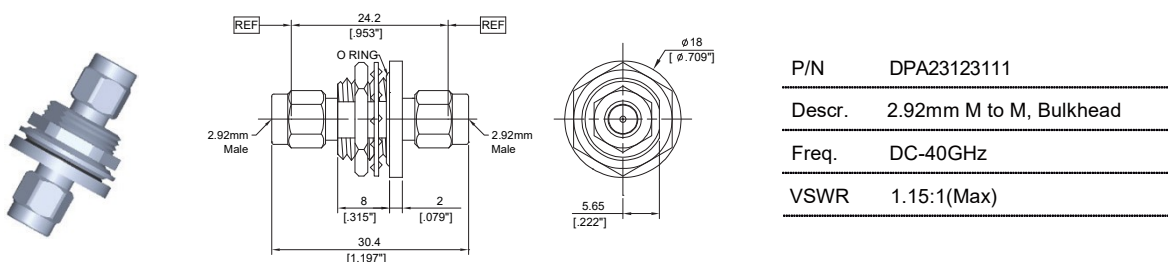
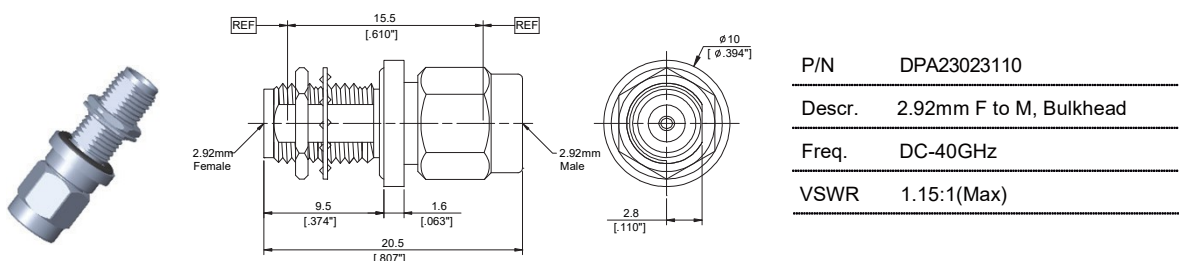
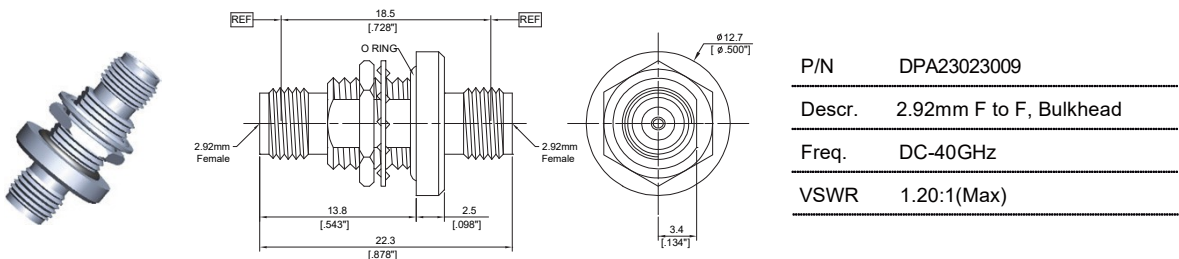
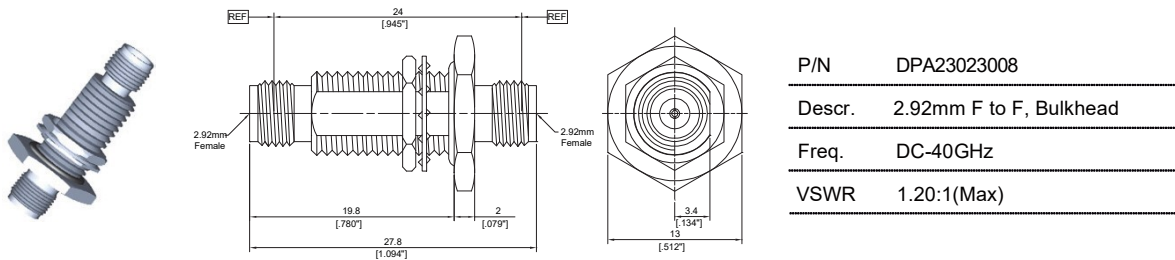
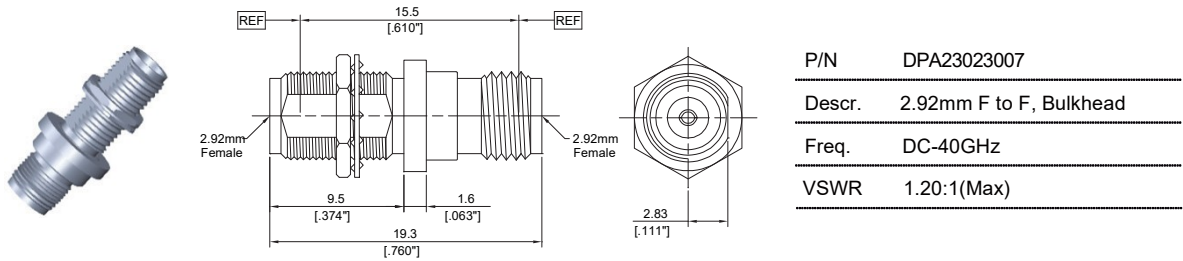
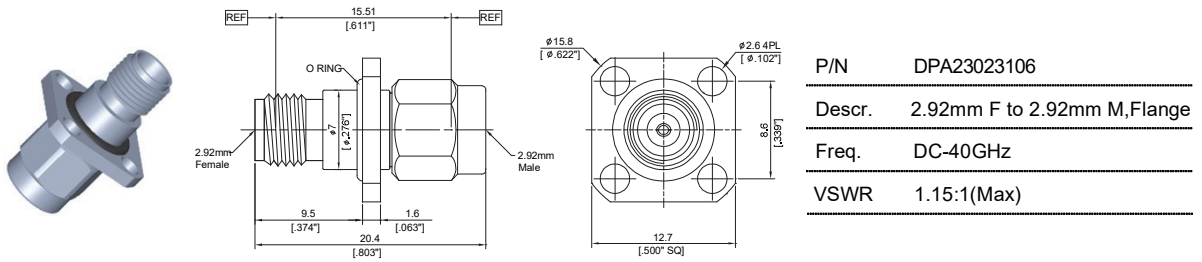

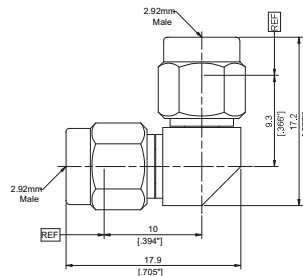

P/N	DPA23023012
Descr.	2.92mm F RA to 2.92mm F
Freq.	DC-40GHz
VSWR	1.25:1(Max)

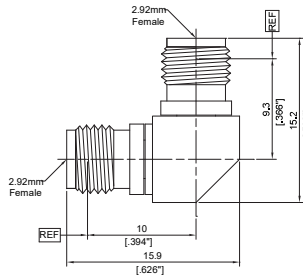

P/N	DPA23023113
Descr.	2.92mm F RA to 2.92mm M
Freq.	DC-40GHz
VSWR	1.25:1(Max)

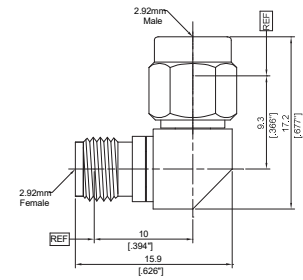

P/N	DPA23123114
Descr.	2.92mm M RA to 2.92mm M
Freq.	DC-40GHz
VSWR	1.25:1(Max)