

ELECTRICAL SPECIFICATIONS

Frequency Range: 3.5-4.3 GHz
 Impedance: 50 Ohm
 Insertion Loss: 0.4 dB max.
 Isolation: 20 dB min.
 VSWR: 1.20 max.
 Forward Power: 50 W
 Reserve Power: 20 W
 Operation Temp.: -30 to +70 °C (0.50/18/1.35)

Revisions			
Rev	Description	Date	Approved:
A	Initial Release	2014.11.17	A. M

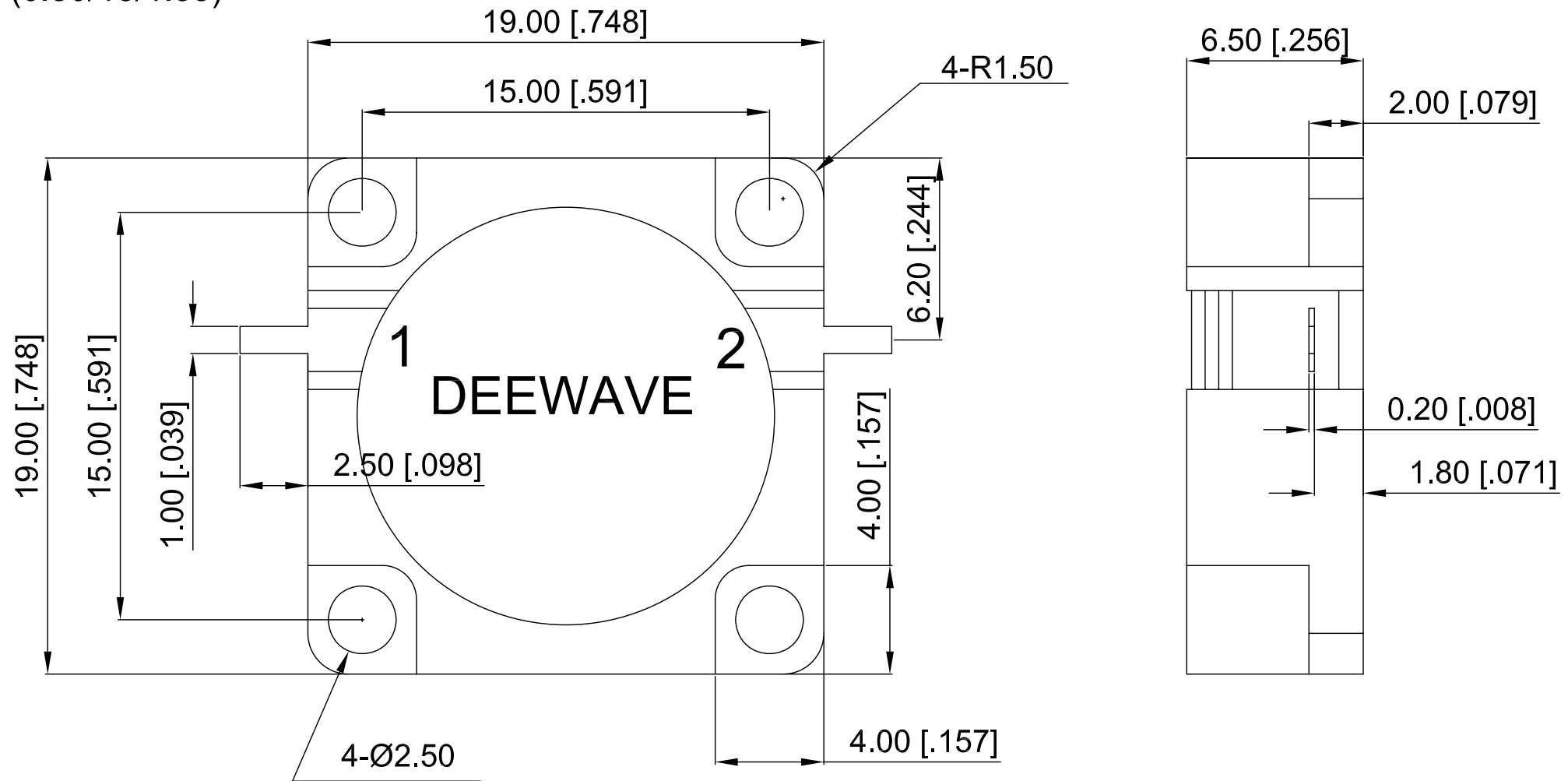

NOTES:
 1. ALL SPECIFICATIONS ARE SUBJECT TO CHANGE WITHOUT NOTICE AT ANY TIME
 2. CUSTOMER OUTLINE DRAWING FOR REFERENCE ONLY

Drawn:	W. Y 2014.11.17
Checked:	T. L 2014.11.17
Approved:	A. M 2014.11.17
Unless Otherwise Specified Dimensions are in Millimeters, Dimensions in [] are in Inches for Customer Reference Only. Unless Otherwise Specified Tolerance are: .XX ±0.13 [.005"] .X ±0.20 [.008"] X ±0.50 [.019"] .X° ±1° X° ±2°	

Title:	Drop-in Isolator Freq 3.5-4.3 GHz
Part No:	DDI350430

DEEWAVE
www.deewave.com

View:

Size:	Scale:	Sheet:	Rev:
A3	4:1	1/1	A