

Product Model: WR42 WG Isolator
 Frequency Range (GHz): 20.2~21.2GHz
 Insertion Loss : 0.30 dB Max.
 Isolation : 20 dB Min.
 VSWR: 1.20 Max.
 Forward Power: 2 W
 Reverse Power: 1 W

Revisions			
Rev	Description	Date	Approved:
A	Initial Release	2014.3.3	A. M

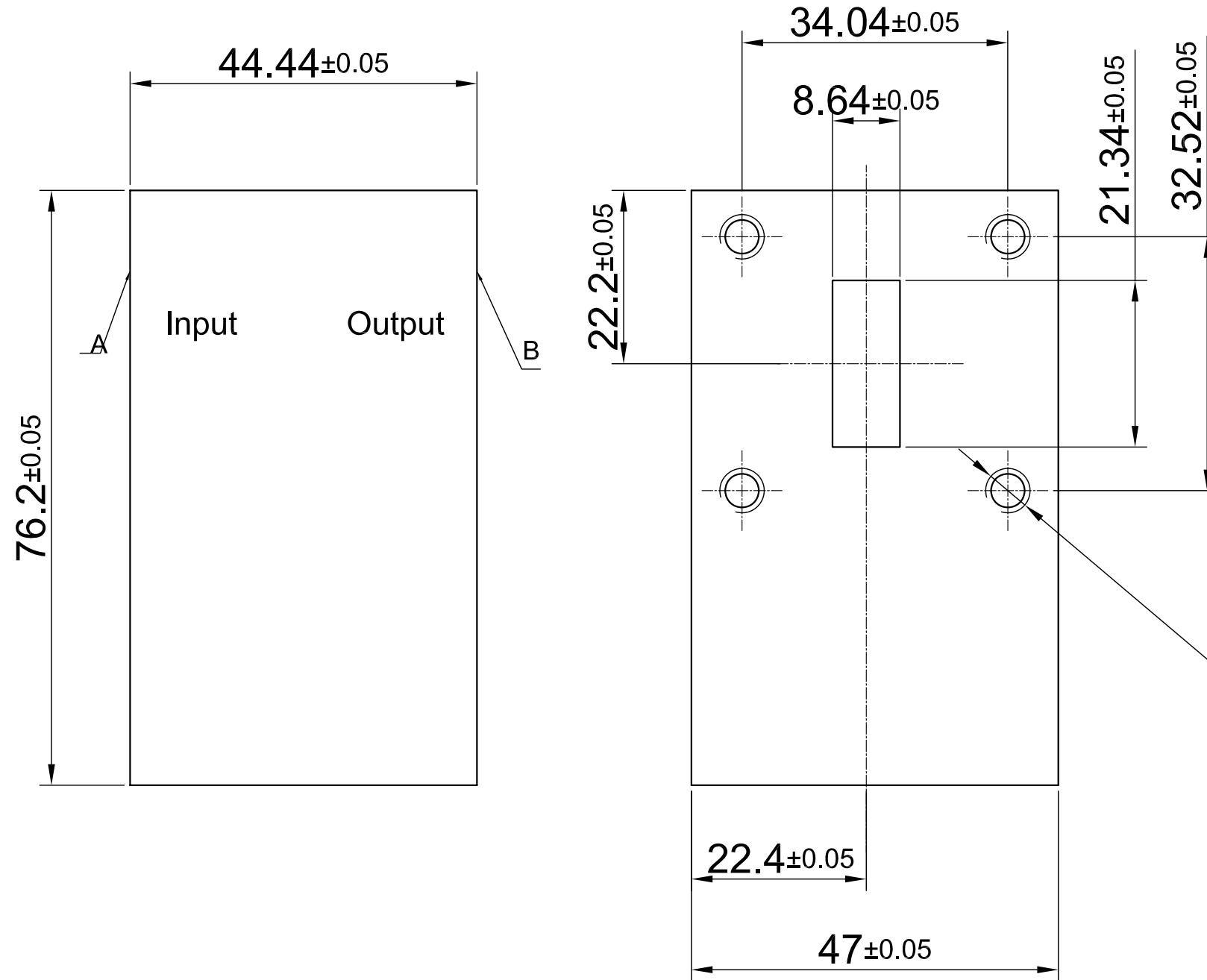

8X #4-40UNC-2B
4.0[.157] MAX DEEP
 TAP FROM BOTH A
 AND B SIDES

NOTES:

- 1. ALL SPECIFICATIONS ARE SUBJECT TO CHANGE WITHOUT NOTICE AT ANY TIME
- 2. CUSTOMER OUTLINE DRAWING FOR REFERENCE ONLY

Drawn:	W. Y 2014.3.3
Checked:	T. L 2014.3.3
Approved:	A. M 2014.3.3
<small>Unless Otherwise Specified Dimensions are in Millimeters, Dimensions in [] are in Inches for Customer Reference Only. Unless Otherwise Specified Tolerance are: .XX ±0.13 [.005"] .X ±0.20 [.008"] X ±0.50 [.019"] .X° ±1° X° ±2°</small>	

Title:	Waveguide Isolator Freq at 20.2~21.2GHz
Part No:	DWI20202120

DEEWAVE
www.deewave.com

View:

Size:	Scale:	Sheet:	Rev:
A3	1:1	1/1	A