

**ELECTRICAL SPECIFICATIONS**

Frequency Range: 9.5-10.5 GHz

Impedance: 50 Ohm

Insertion Loss: 0.3 dB max.

Isolation: 23 dB min.

VSWR: 1.20 max.

Forward Power: 10 W

Reserve Power: 5 W

Revisions			
Rev	Description	Date	Approved:
A	Initial Release	2014.12.24	A. M

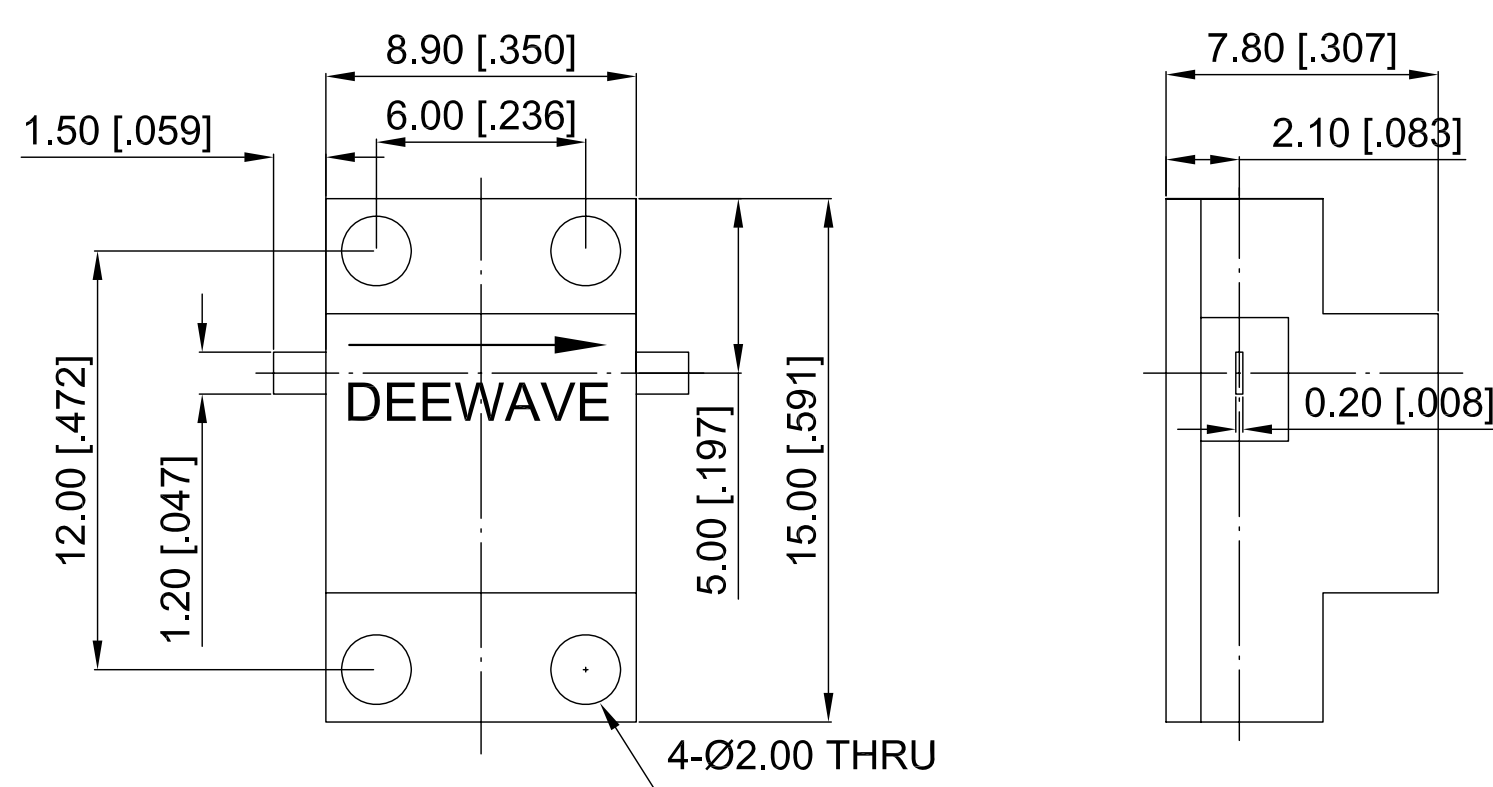

- NOTES:
1. ALL SPECIFICATIONS ARE SUBJECT TO CHANGE WITHOUT NOTICE AT ANY TIME
  2. CUSTOMER OUTLINE DRAWING FOR REFERENCE ONLY

Drawn:	W. Y 2014.12.24
Checked:	T. L 2014.12.24
Approved:	A. M 2014.12.24
<small>Unless Otherwise Specified Dimensions are in Millimeters,  Dimensions in [ ] are in Inches for Customer Reference Only.  Unless Otherwise Specified Tolerance are:  .XX ±0.13 [.005"] .X ±0.20 [.008"] X ±0.50 [.019"]  .X° ±1° X° ±2°</small>	

Title:	<b>Drop-in Isolator Freq 9.5-10.5 GHz</b>
Part No:	<b>DDI9501050</b>

**DEEWAVE**  
www.deewave.com

View:

Size: A3	Scale: 4:1	Sheet: 1/1	Rev: A
----------	------------	------------	--------