

Product Model: Drop-in Isolator
 Frequency Range (GHz): 8.70-10.40GHz
 Insertion Loss : 0.40 dB Max.
 Isolation : 23 dB Min.
 VSWR: 1.20 Max.
 Forward Power 10W
 Reverse Power 5W

Revisions			
Rev	Description	Date	Approved:
A	Initial Release	2013.5.24	A. M

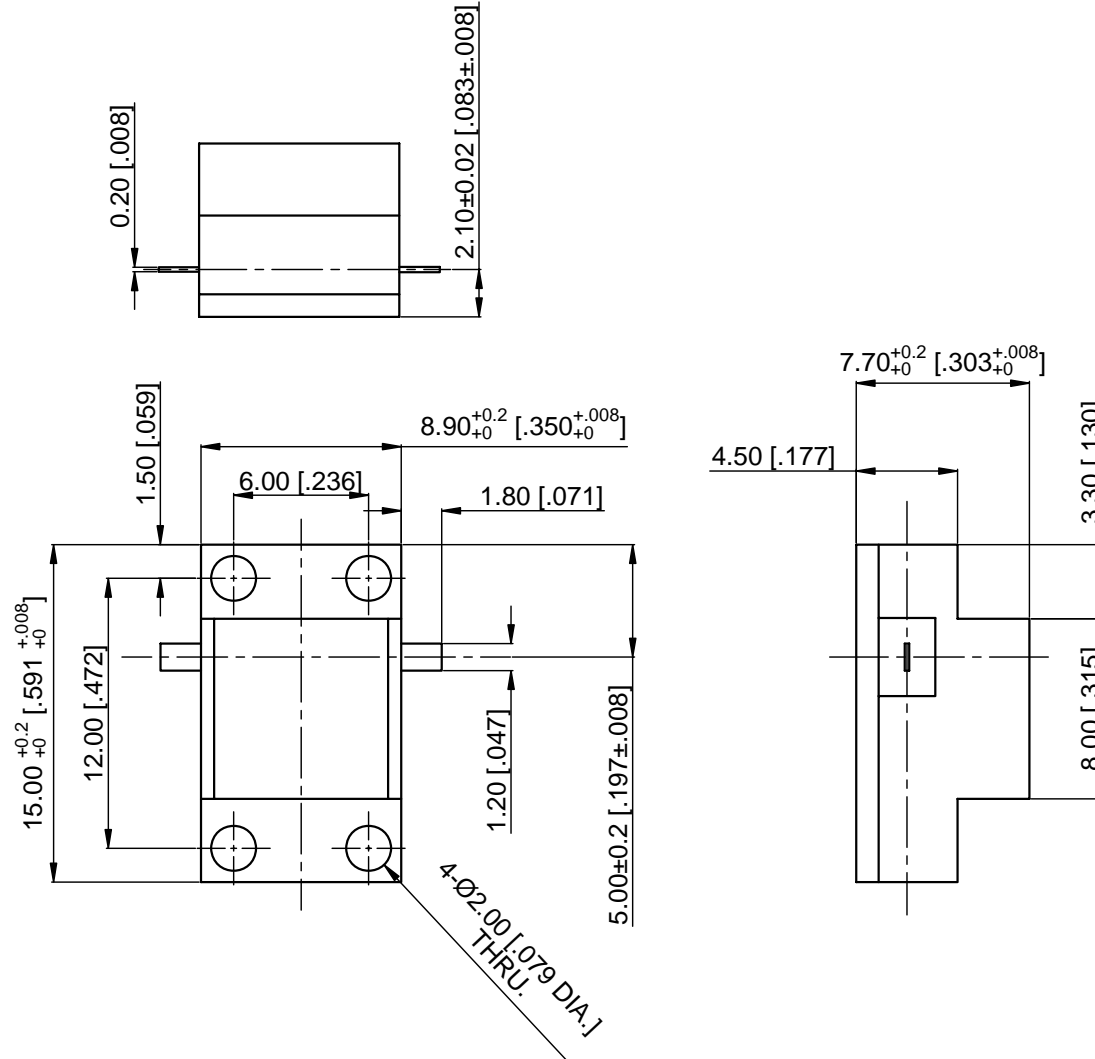

NOTES:

1. ALL SPECIFICATIONS ARE SUBJECT TO CHANGE WITHOUT NOTICE AT ANY TIME
2. CUSTOMER OUTLINE DRAWING FOR REFERENCE ONLY

Drawn:	W. Y 2013.5.24
Checked:	T. L 2013.5.24
Approved:	A. M 2013.5.24
Unless Otherwise Specified Dimensions are in Millimeters, Dimensions in [] are in Inches for Customer Reference Only. Unless Otherwise Specified Tolerance are: .XX ±0.13 [.005"] .X ±0.20 [.008"] X ±0.50 [.019"] .X° ±1° X° ±2°	

Title:	Drop-in Isolator 8.7-10.4GHz
Part No:	DDI8701040

DEEWAVE
www.deewave.com

View:

Size: A3	Scale: 2:1	Sheet: 1/1	Rev: A
----------	------------	------------	--------