

ELECTRICAL SPECIFICATIONS

Frequency Range: 12.5-13.5 GHz

Impedance: 50 Ohm

Insertion Loss: 0.4 dB max.

Isolation: 20 dB min.

VSWR: 1.25 max.

Forward Power: 30 W

Reserve Power: 5 W

Revisions			
Rev	Description	Date	Approved:
A	Initial Release	2016.1.27	A. M

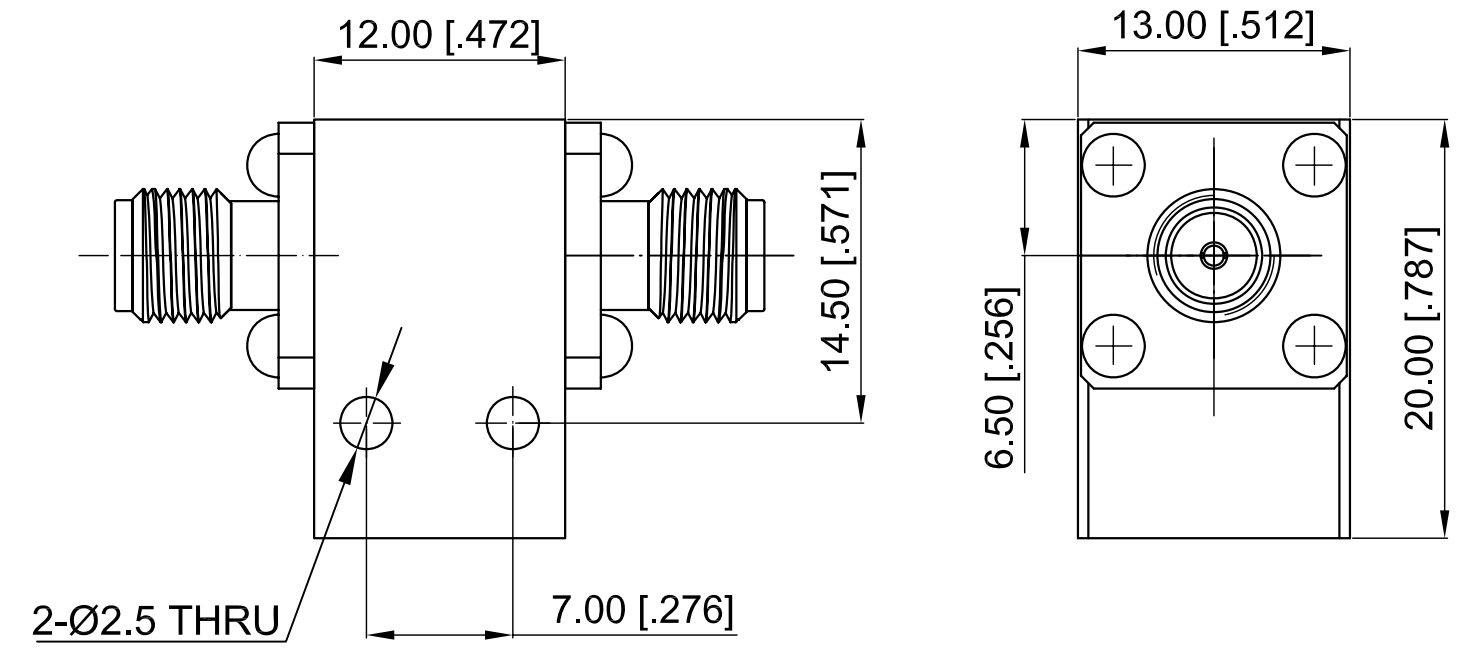

NOTES:
 1. ALL SPECIFICATIONS ARE SUBJECT TO CHANGE WITHOUT NOTICE AT ANY TIME
 2. CUSTOMER OUTLINE DRAWING FOR REFERENCE ONLY

Drawn:	W. Y 2016.1.27
Checked:	T. L 2016.1.27
Approved:	A. M 2016.1.27
Unless Otherwise Specified Dimensions are in Millimeters, Dimensions in [] are in Inches for Customer Reference Only. Unless Otherwise Specified Tolerance are: .XX ±0.13 [.005"] .X ±0.20 [.008"] X ±0.50 [.019"] .X° ±1° X° ±2°	

Title:	SMA Isolator Freq 12.5-13.5 GHz
Part No:	DCI12501350

DEEWAVE
www.deewave.com

View:

Size:	Scale:	Sheet:	Rev:
A3	4:1	1/1	A